

IOS Smart Home Application Software (AP-ISH100)

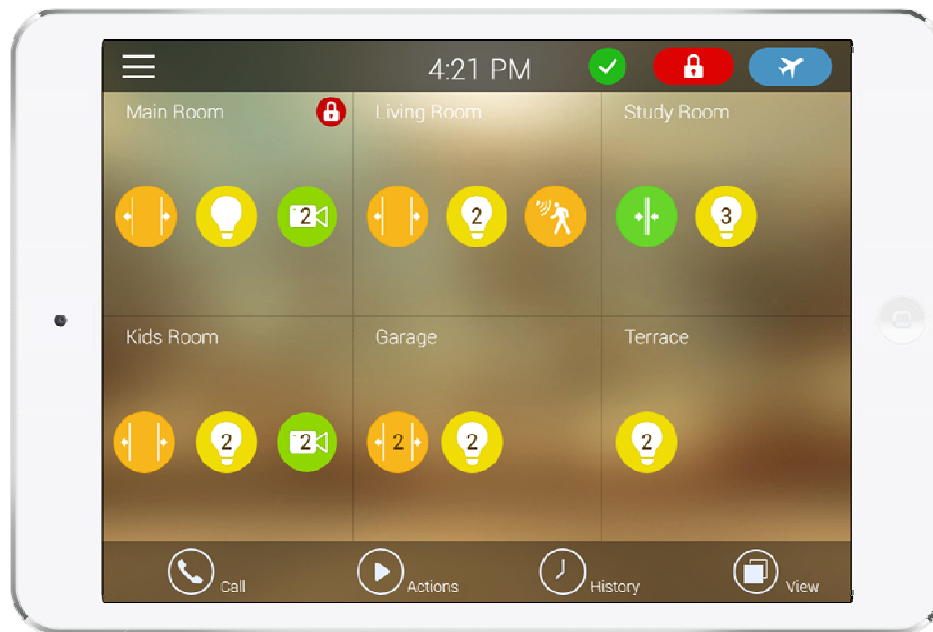

AddPac

AddPac Technology

2015, Sales and Marketing

www.addpac.com

Contents

- AP-ISH100 IOS Smart Home Appl. Overview
- AP-ISH100 Network Service Diagram
- AP-ISH100 SIP Register Diagram
- AP-ISH100 SIP Video Call Flow Diagram
- AP-ISH100 UI Design (examples)

IOS Smart Home Software (Apple IOS App.)



AP-ISH100 Overview

- It supports receiving a video call from video door phone by visitor.
- It supports making a video call to video door phone to see door side.
- It supports bidirectional video call from security guard video phone.
- It supports smart hub devices for sensor device handling.
- It supports IP camera view mode using RTSP protocol
- It supports standard based SIP signaling protocol.
- It supports below voice and video codecs
 - Voice Codec : G.711ulaw/alaw, G.726
 - Video Codec : H.264, H.263, MPEG4

AP-ISH100 Network Service Diagram

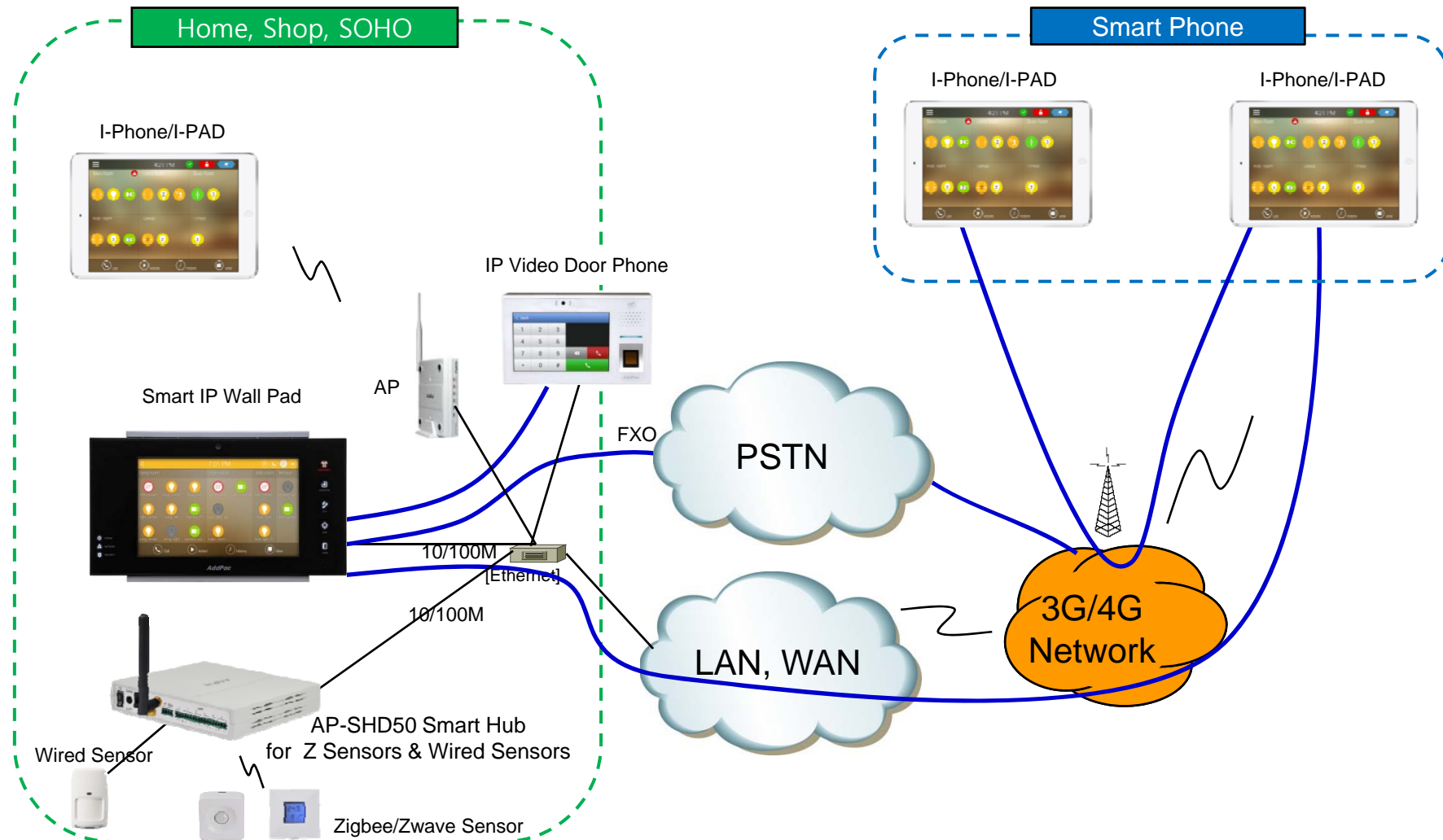

SIP Register

Smart Home Application Register to AP-VWP000

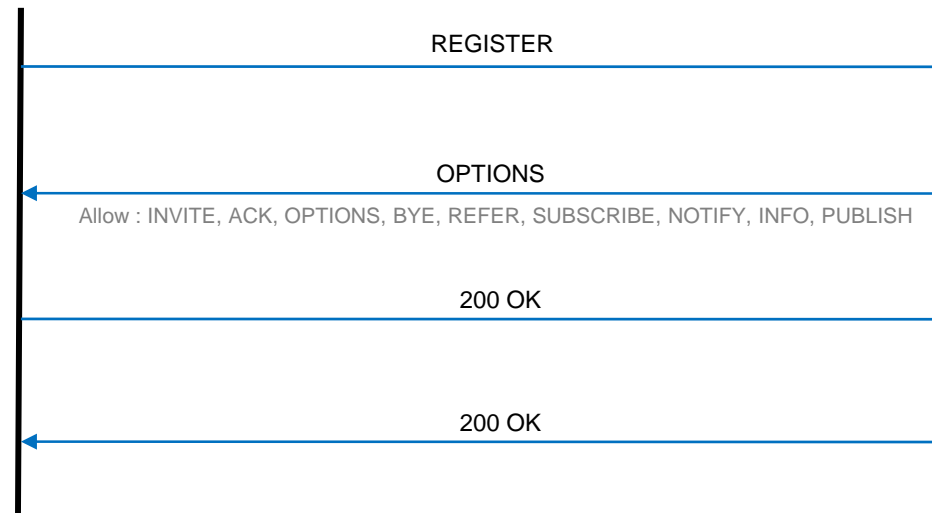
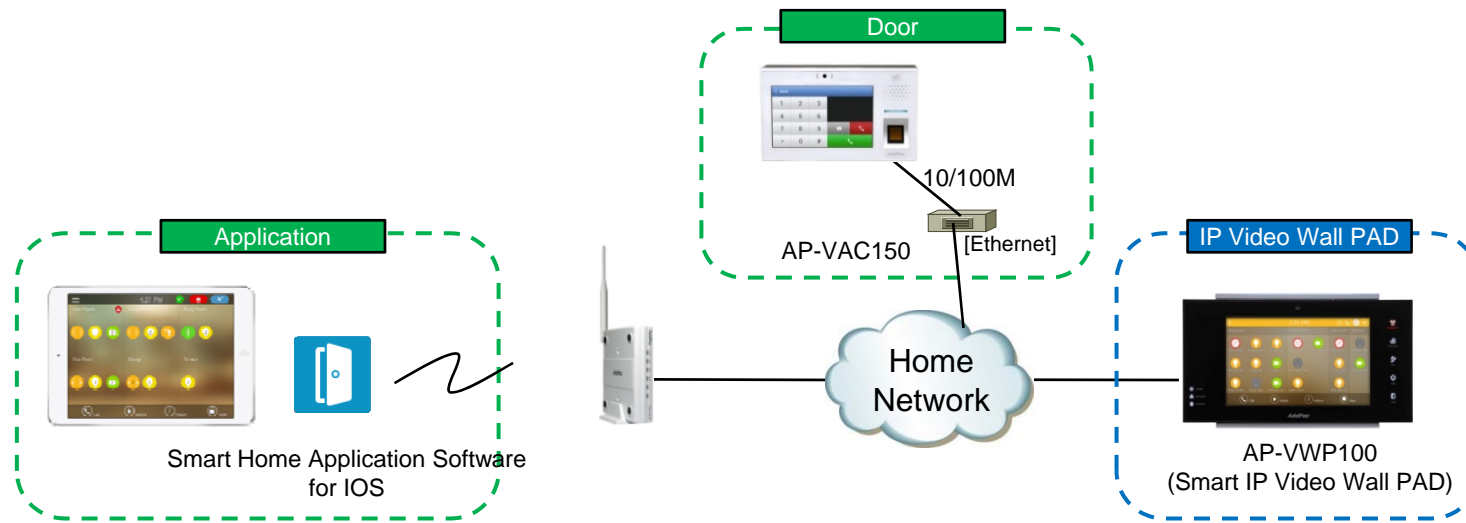

SIP Video Call Flow

Door Open Flow

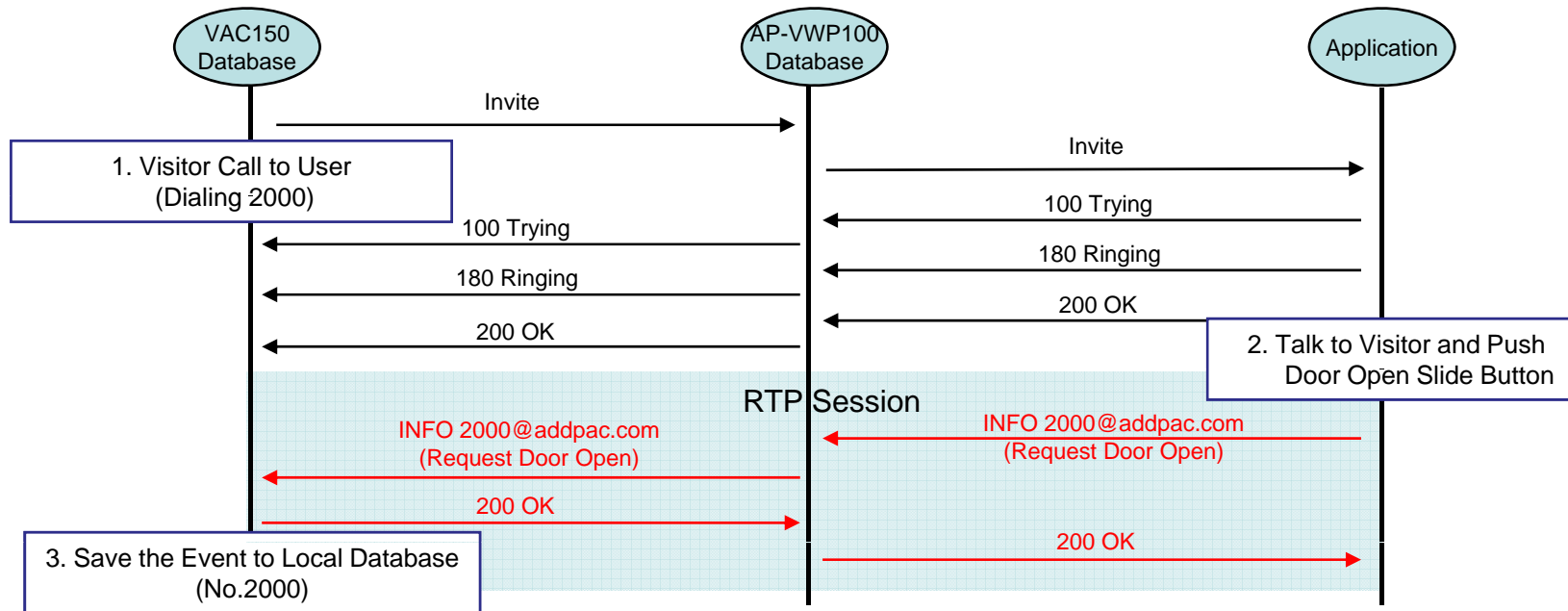

UI examples Lists

- Main View (Zone Summary)
- Armed Mode (Away, Stay, Night)
- Short View
- Zone View
- Zone Setting and Configuration
- IP Camera View Mode (Home, Outside Home)
- Call View (Favorite Call, Recent Call, Phone Book, etc)
- Video Call View
- Sensor Control View (Ex: Light Control, Thermostat, etc)
- Sensor Control View (Action, Mode, Alert, etc)

Main View (Zone Summary)

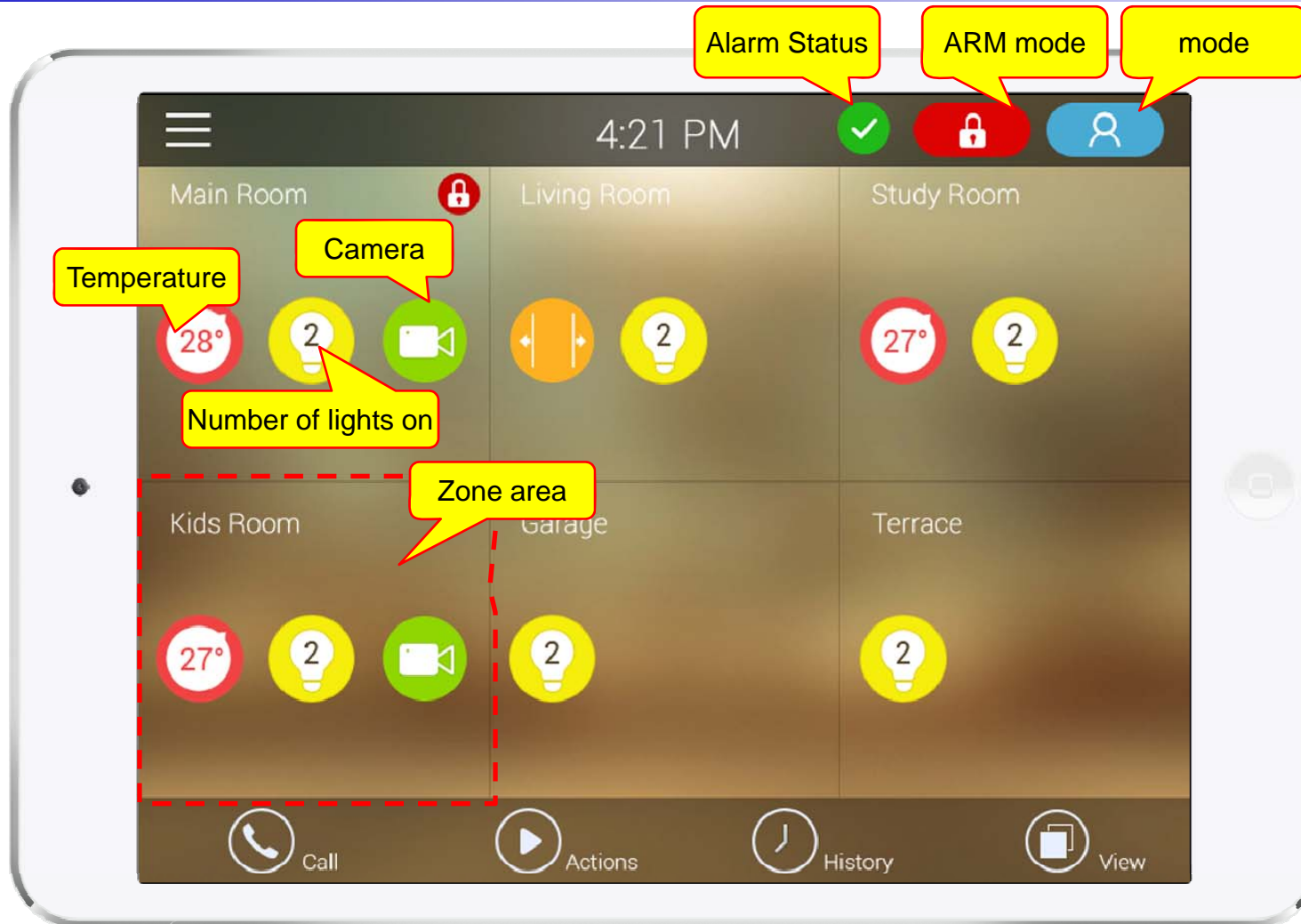

Main View (Cont.)

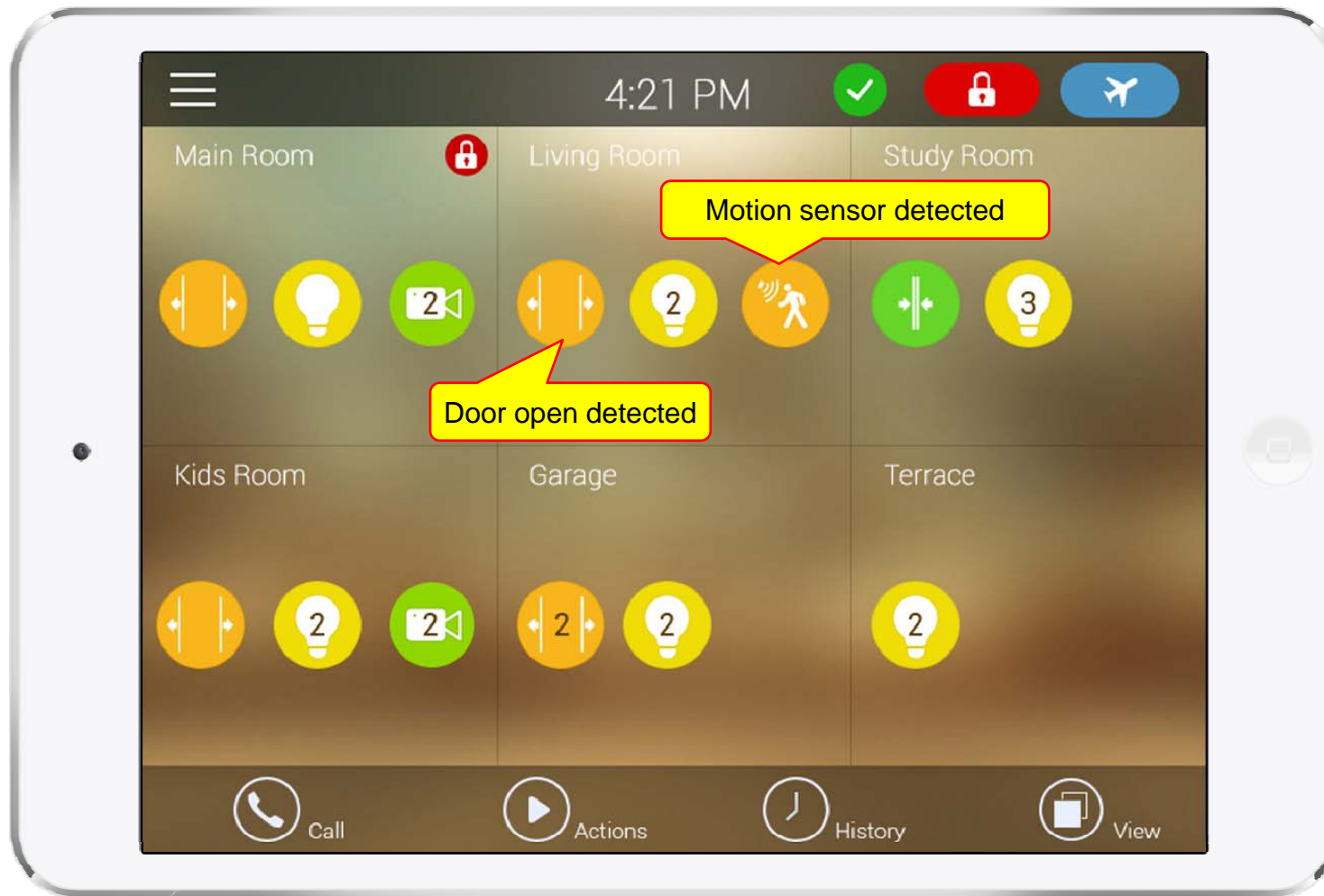

Main View (Zone Detail)

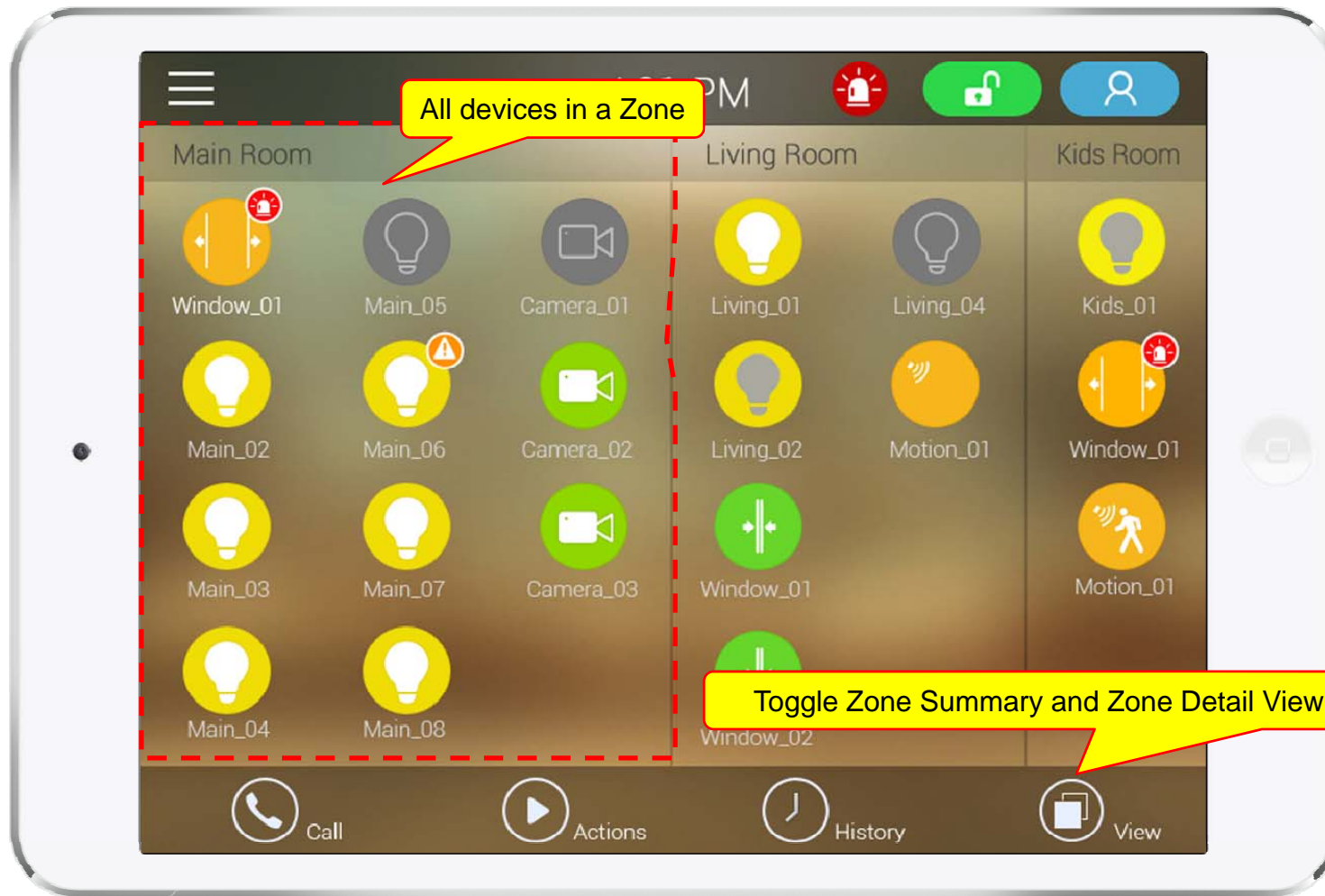

Armed Mode



Short Cut View

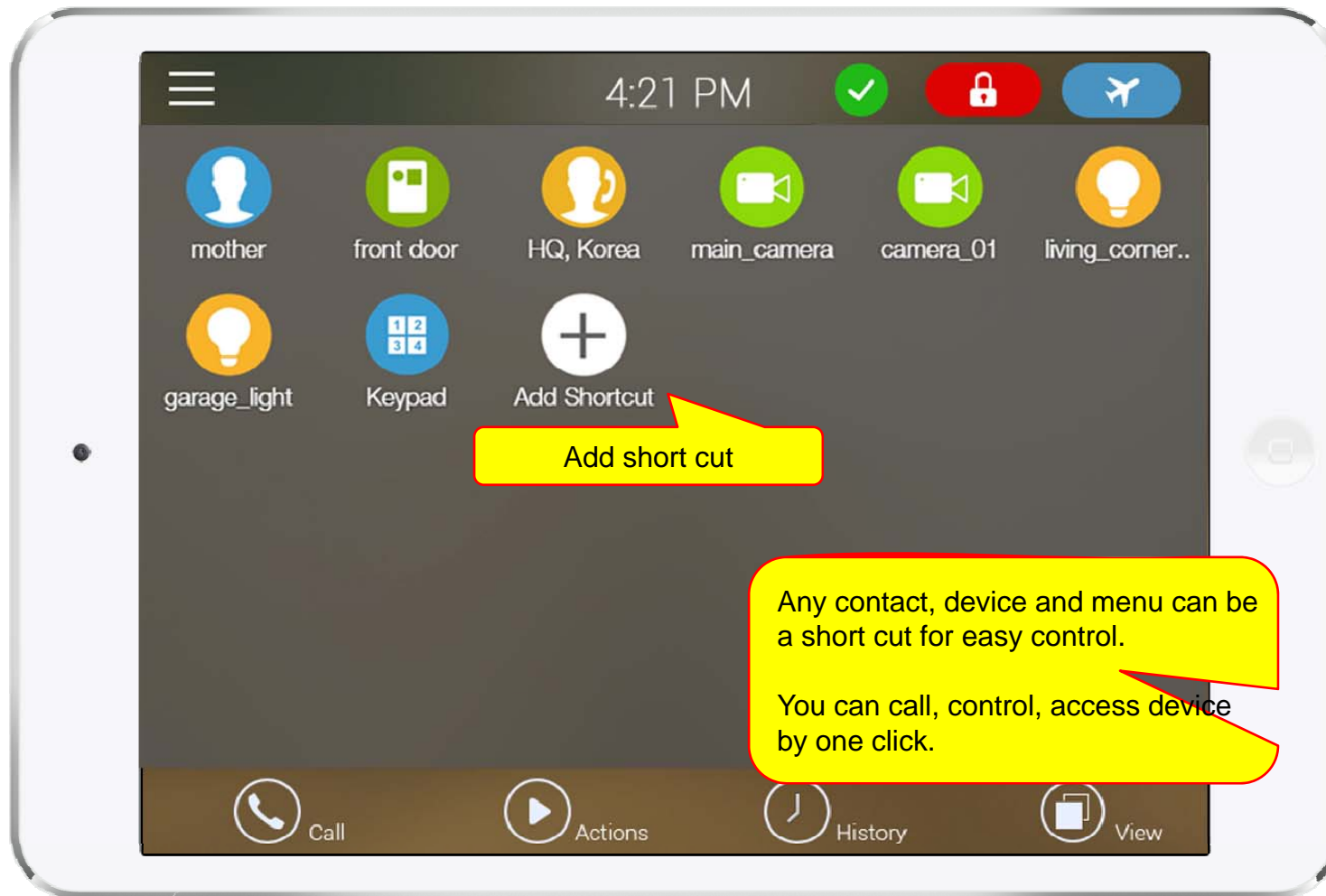

Zone View

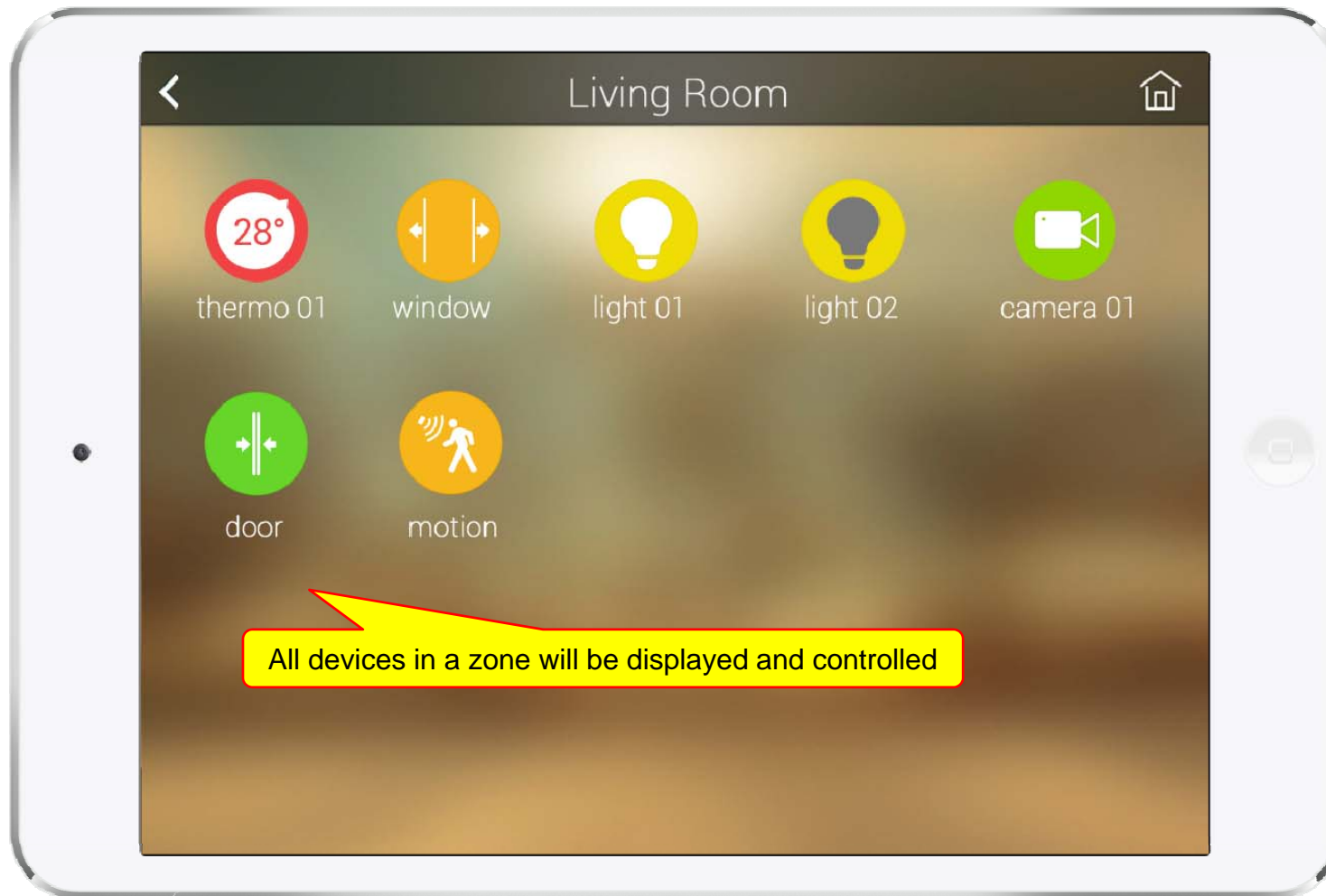

Zone Setting

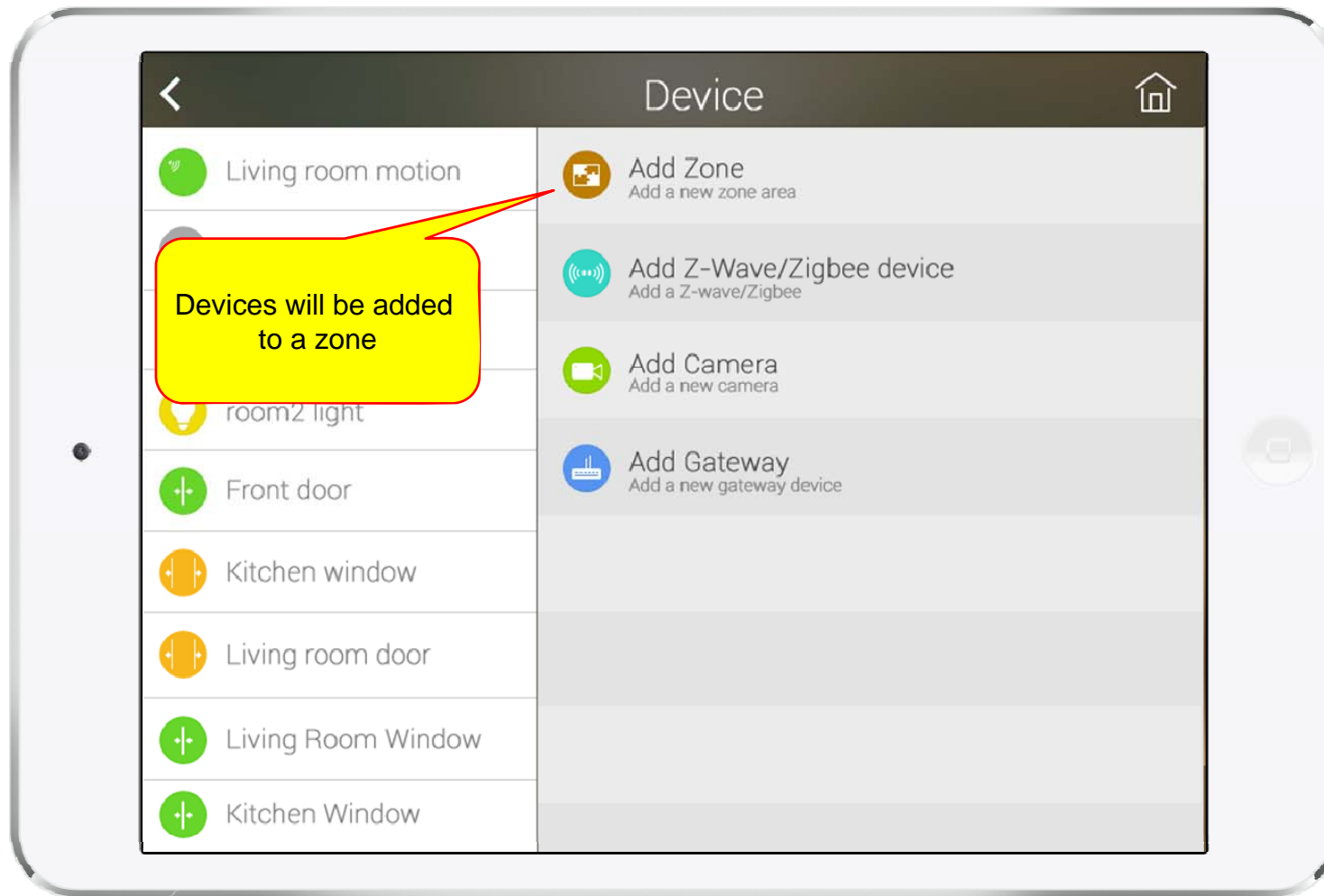

Camera Live View

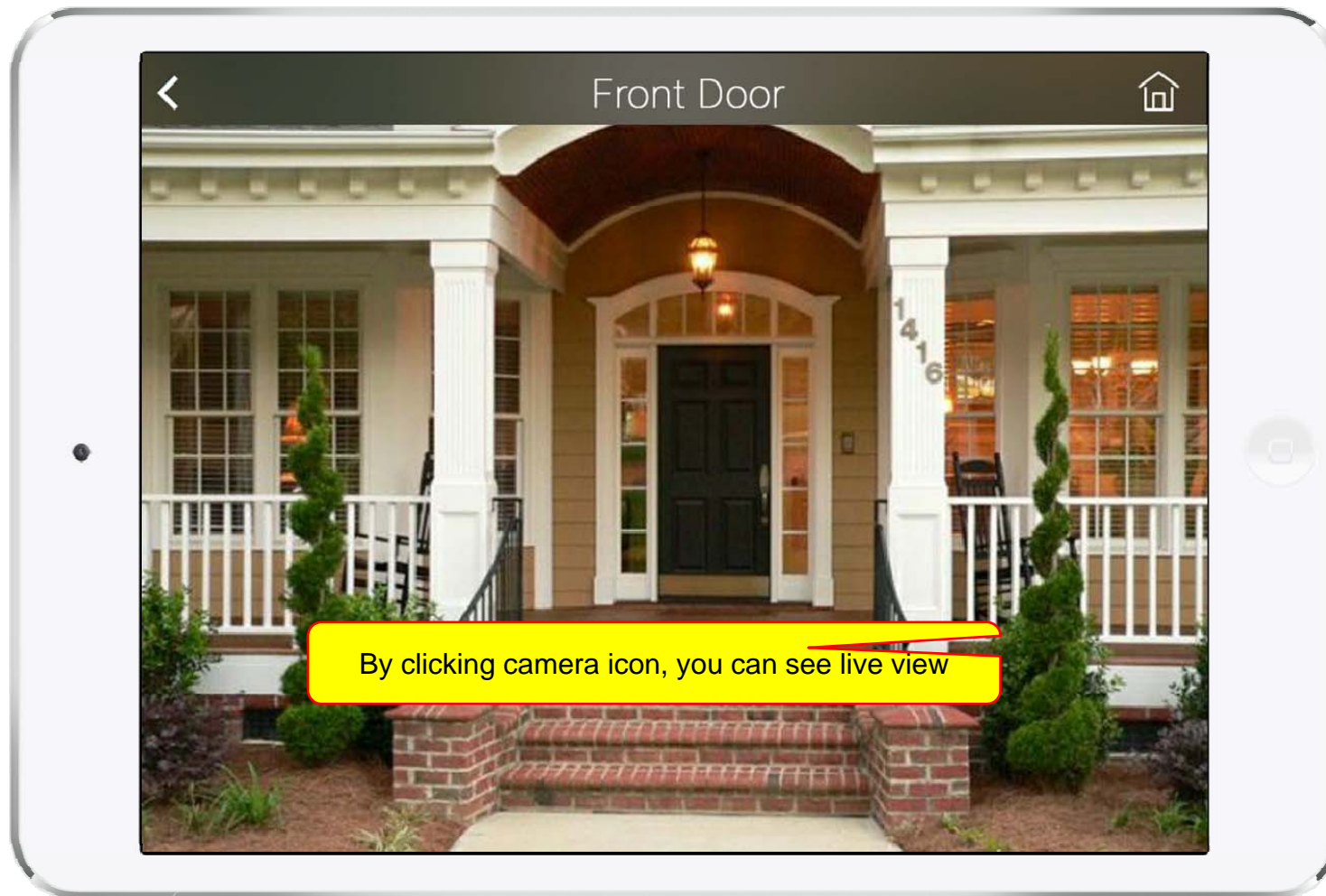

Light Control

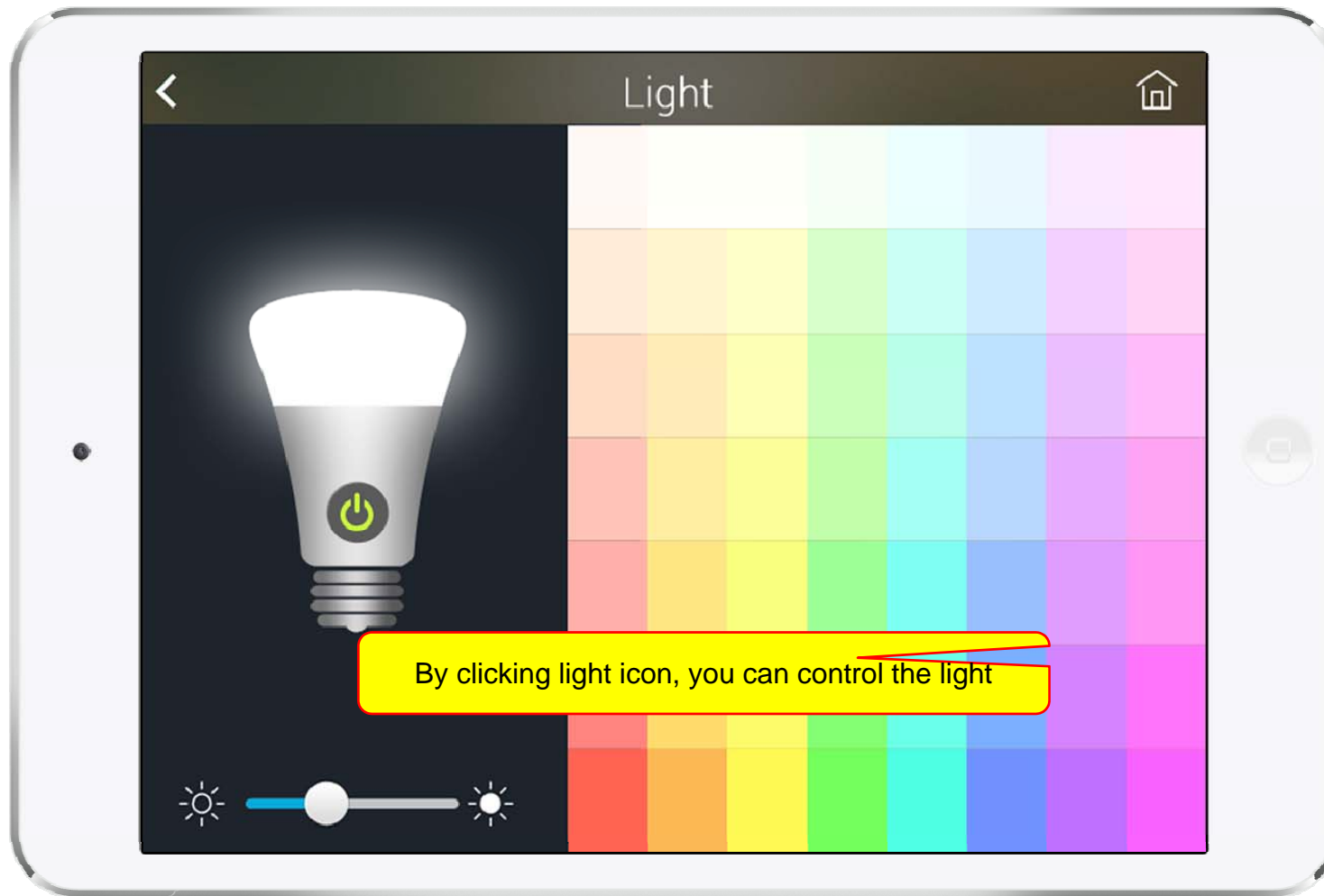

Thermostat

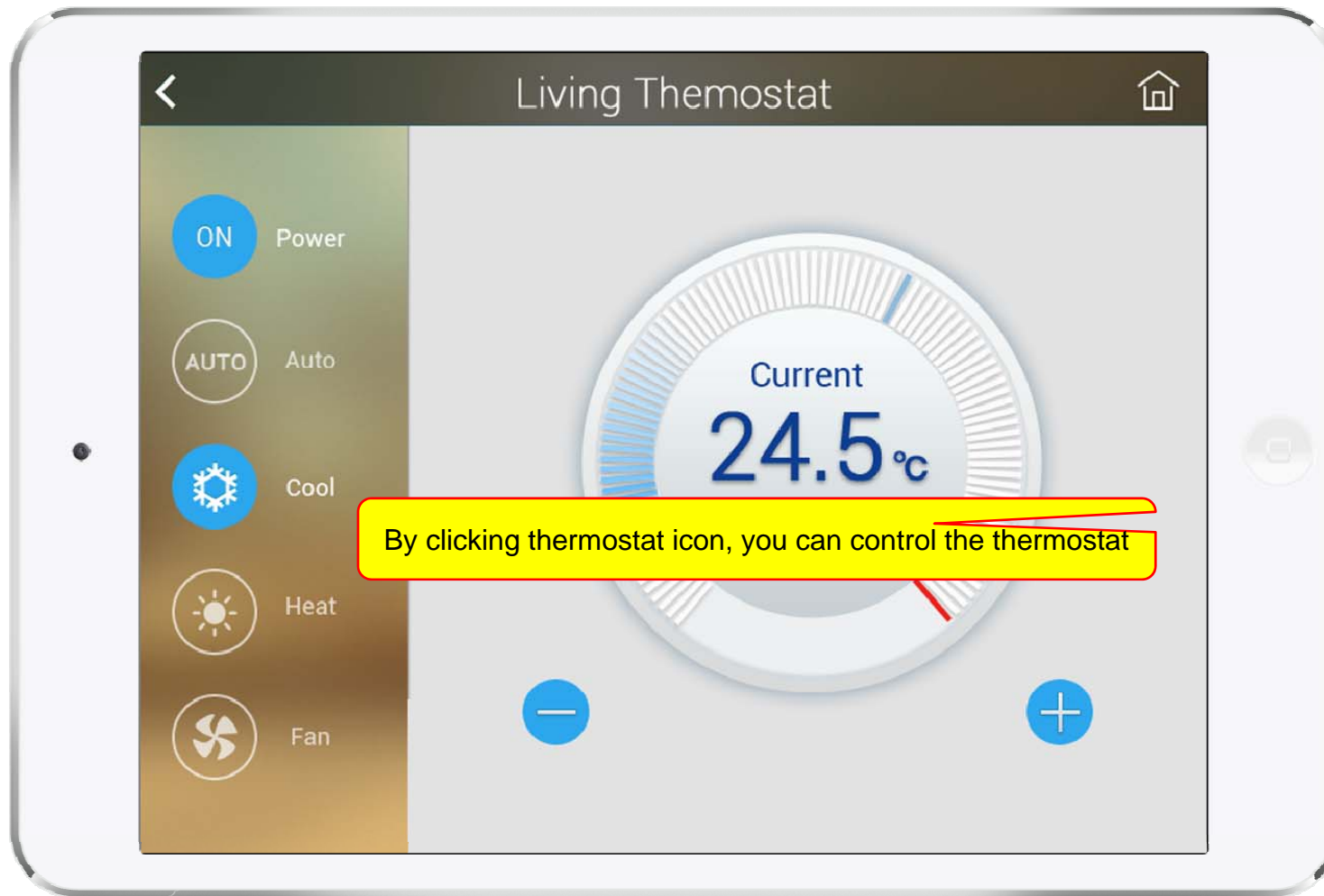

Favorite Call View

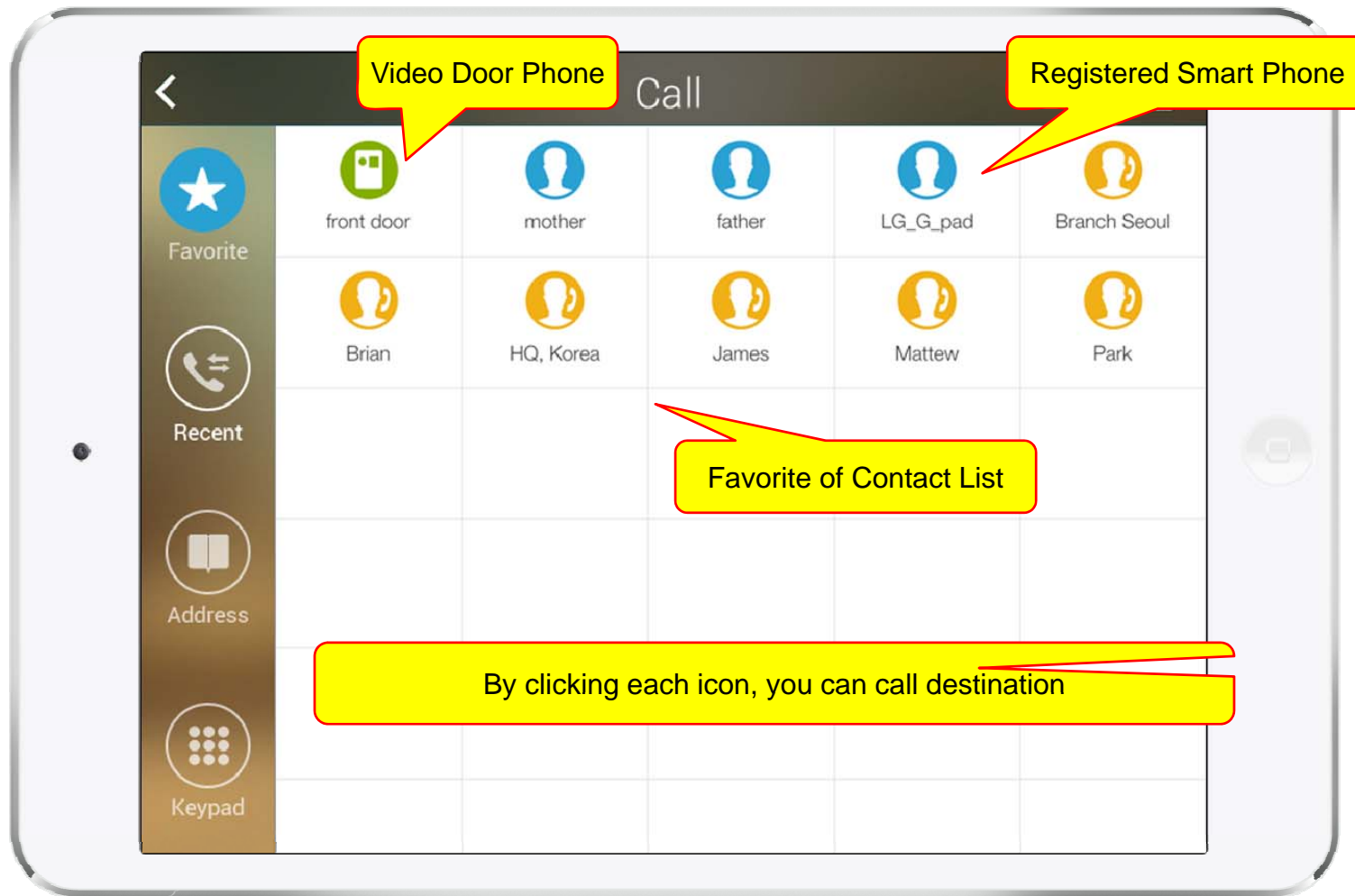

Recent Call View

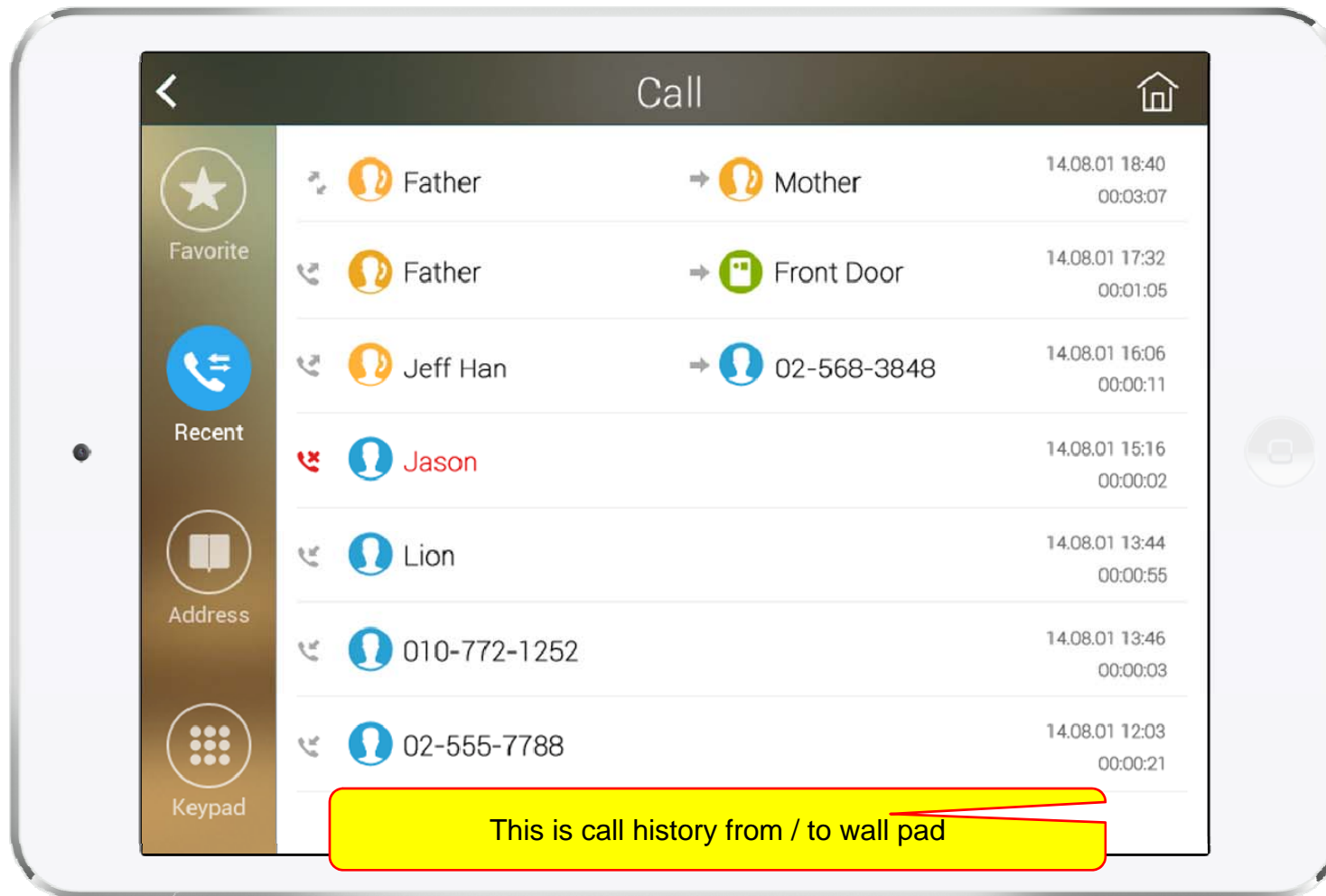

Contact View

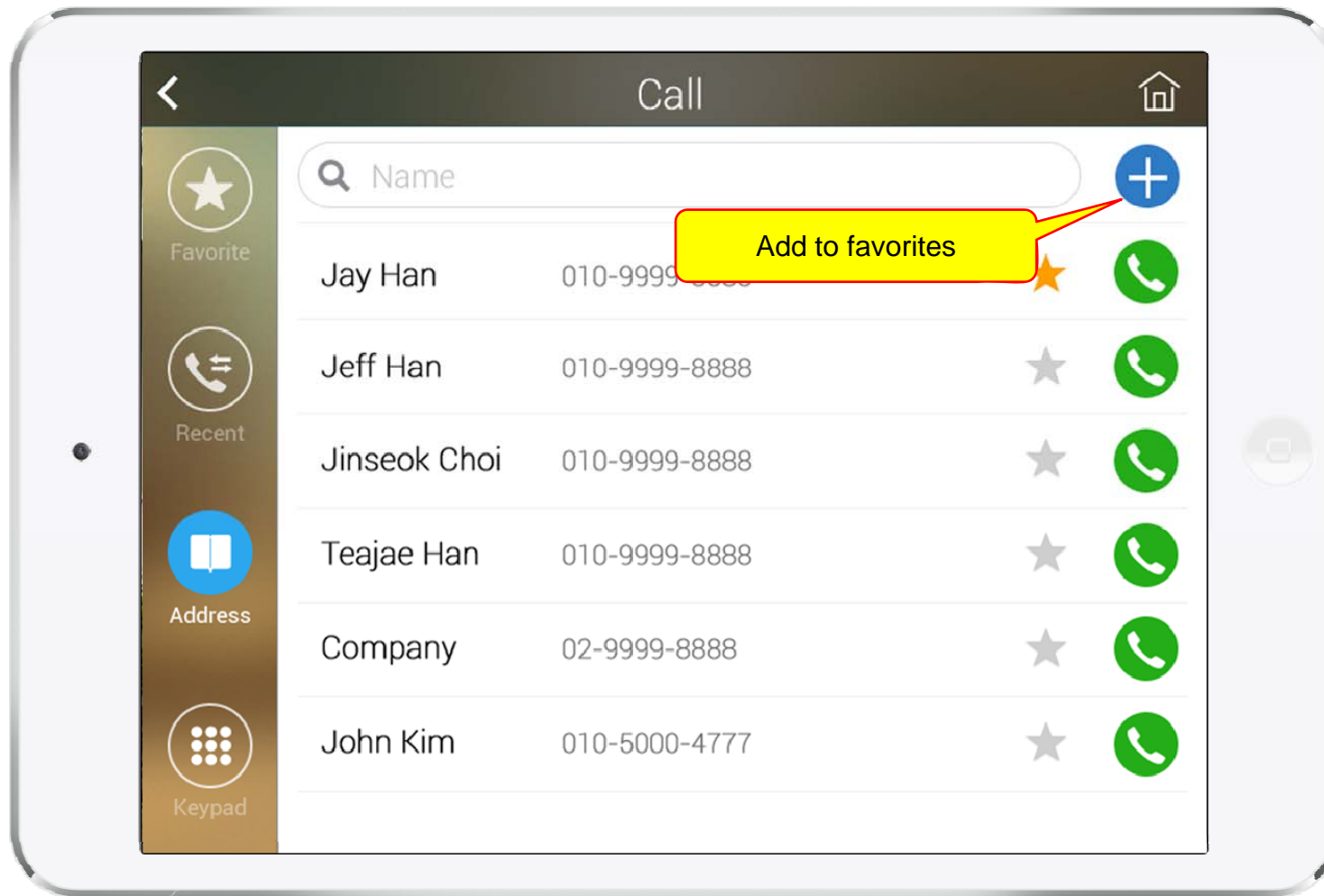

Add Contact

The screenshot shows an iPad interface for adding a contact. At the top, there is a dark header bar with a back arrow on the left, the text 'HQ, Korea' in the center, and a home icon on the right. Below the header, the section is titled 'Contact Info'. It contains two input fields: 'Name*' with the value 'HQ, Korea' and 'Phone Number*' with the value '81-2-567-3849'. Each field has a small 'x' icon to its right. Below these fields is a light gray area with the text 'Please enter the information above.' Underneath that is a 'Favorite' section with a 'Favorite Contact' label and a green toggle switch that is currently turned on. At the bottom of the screen, there are two buttons: a red button with a white 'x' icon and the text 'Delete', and a green button with a white pencil icon and the text 'Done'.

Keypad View

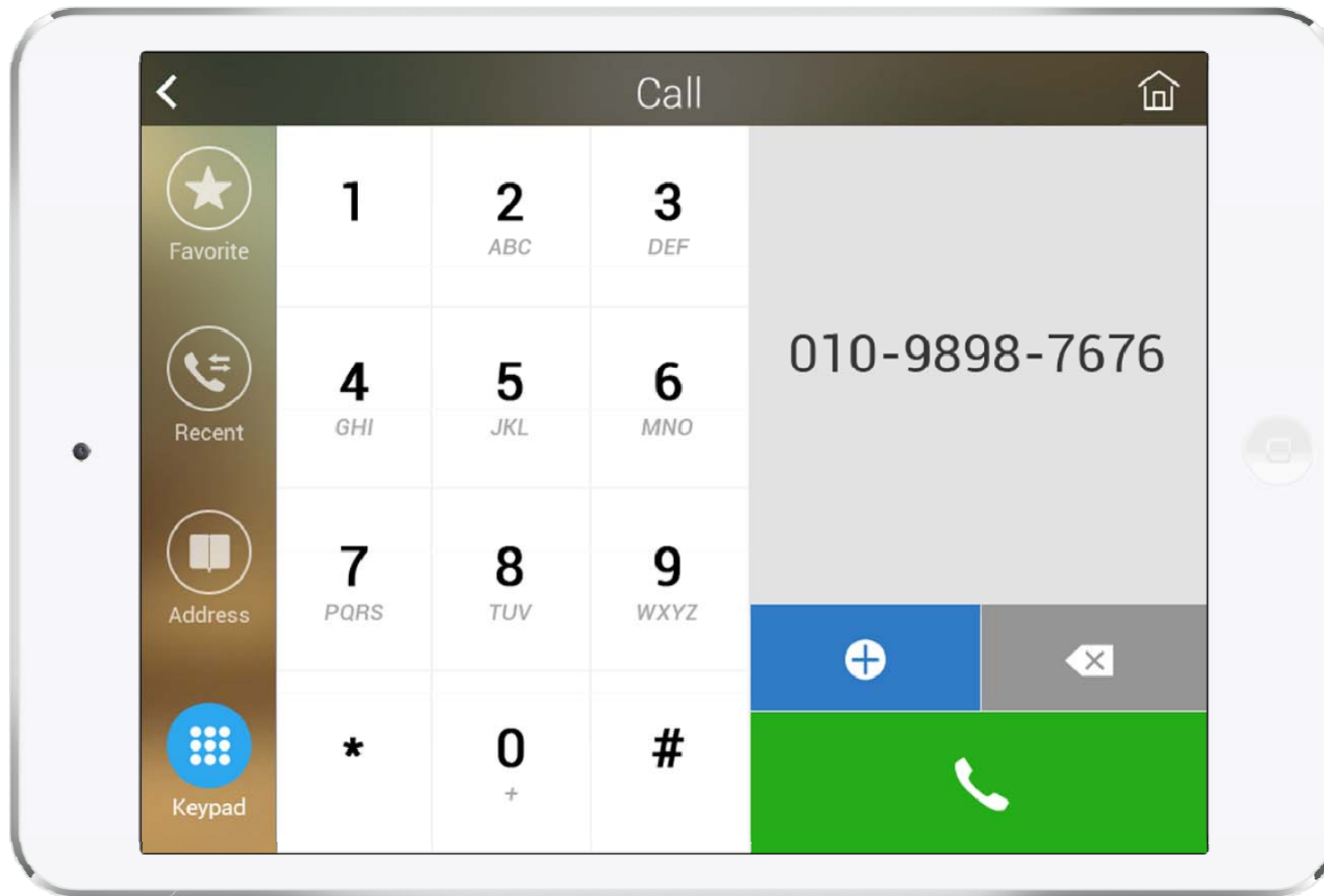

Video Call View

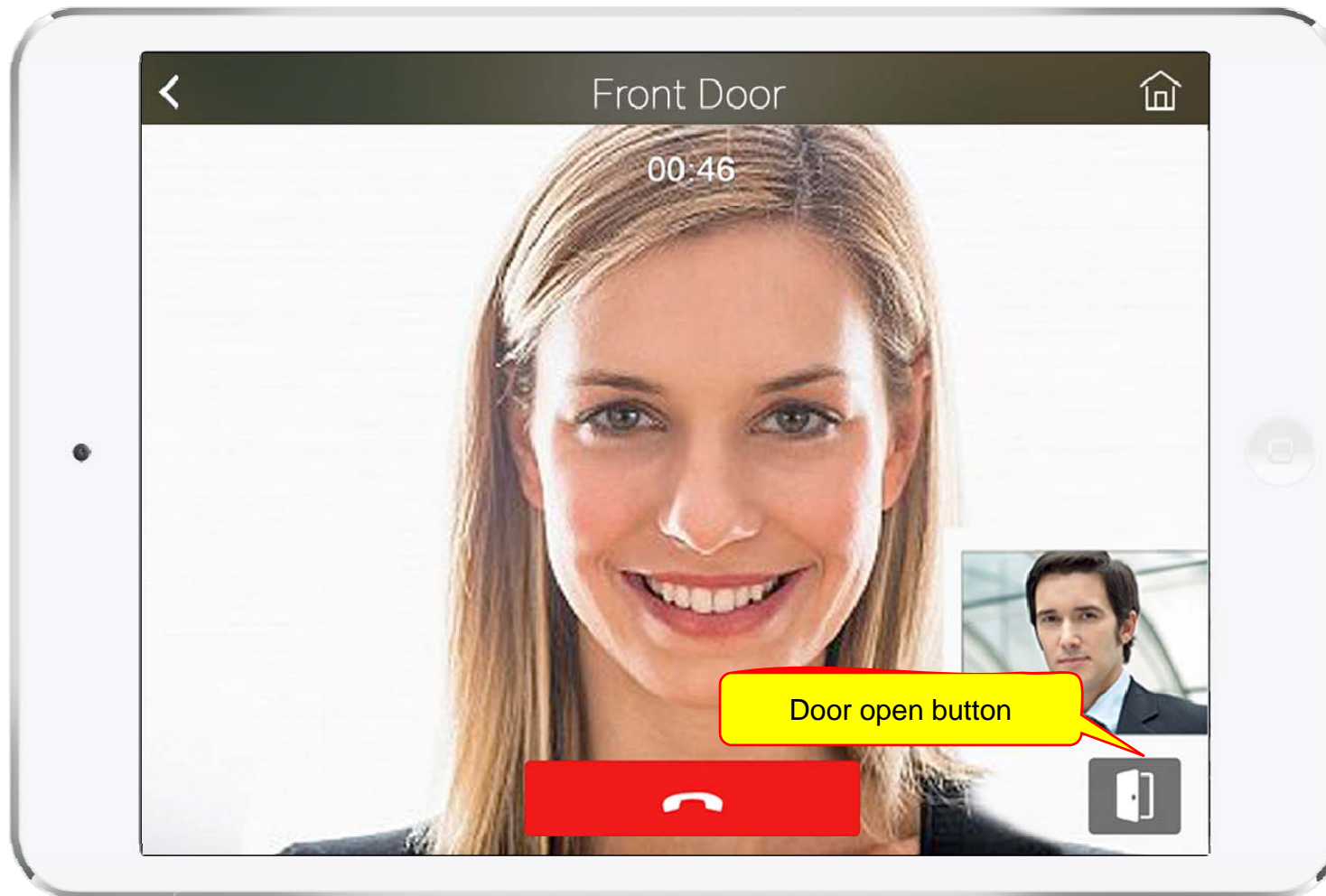

Light Control

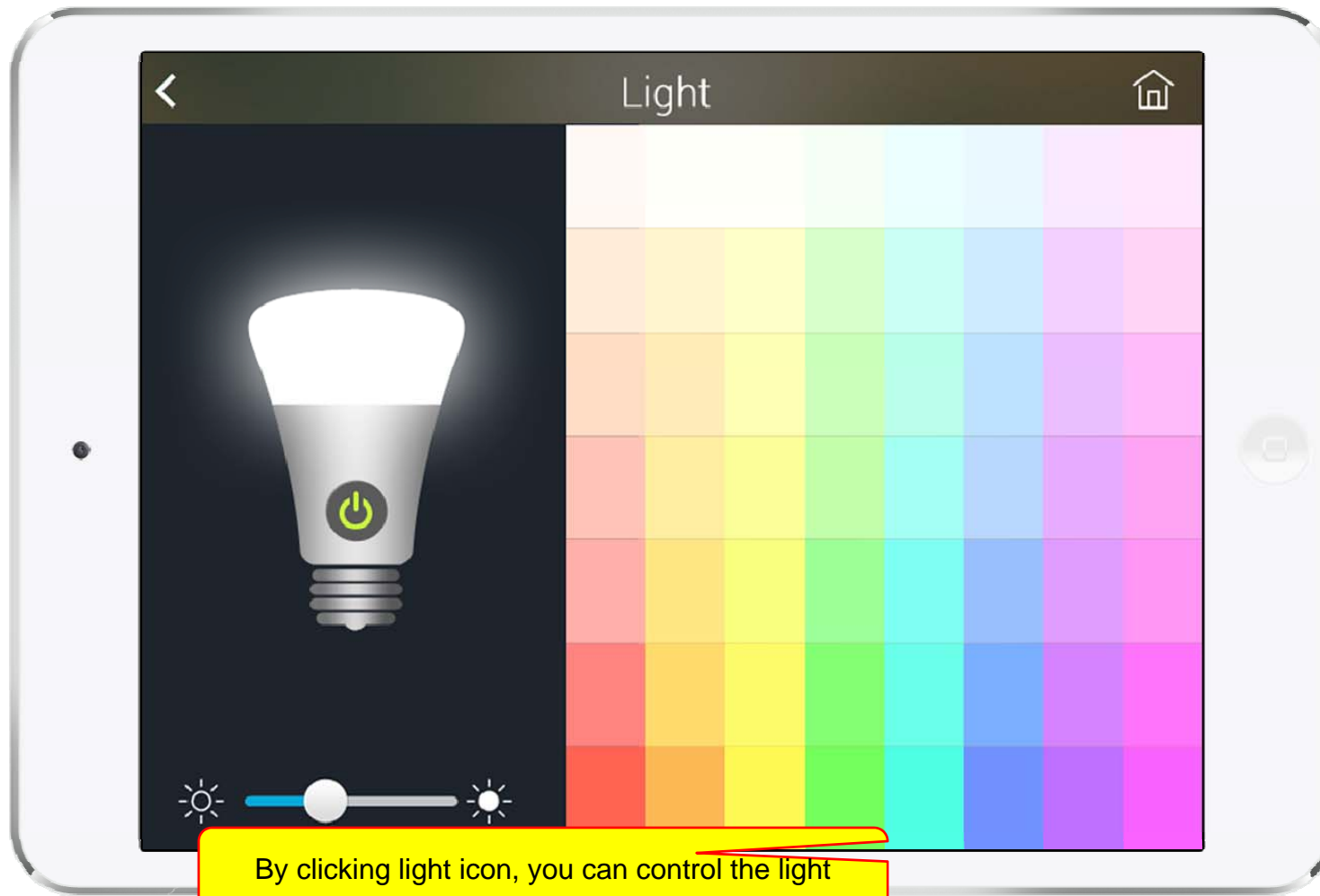

Thermostat

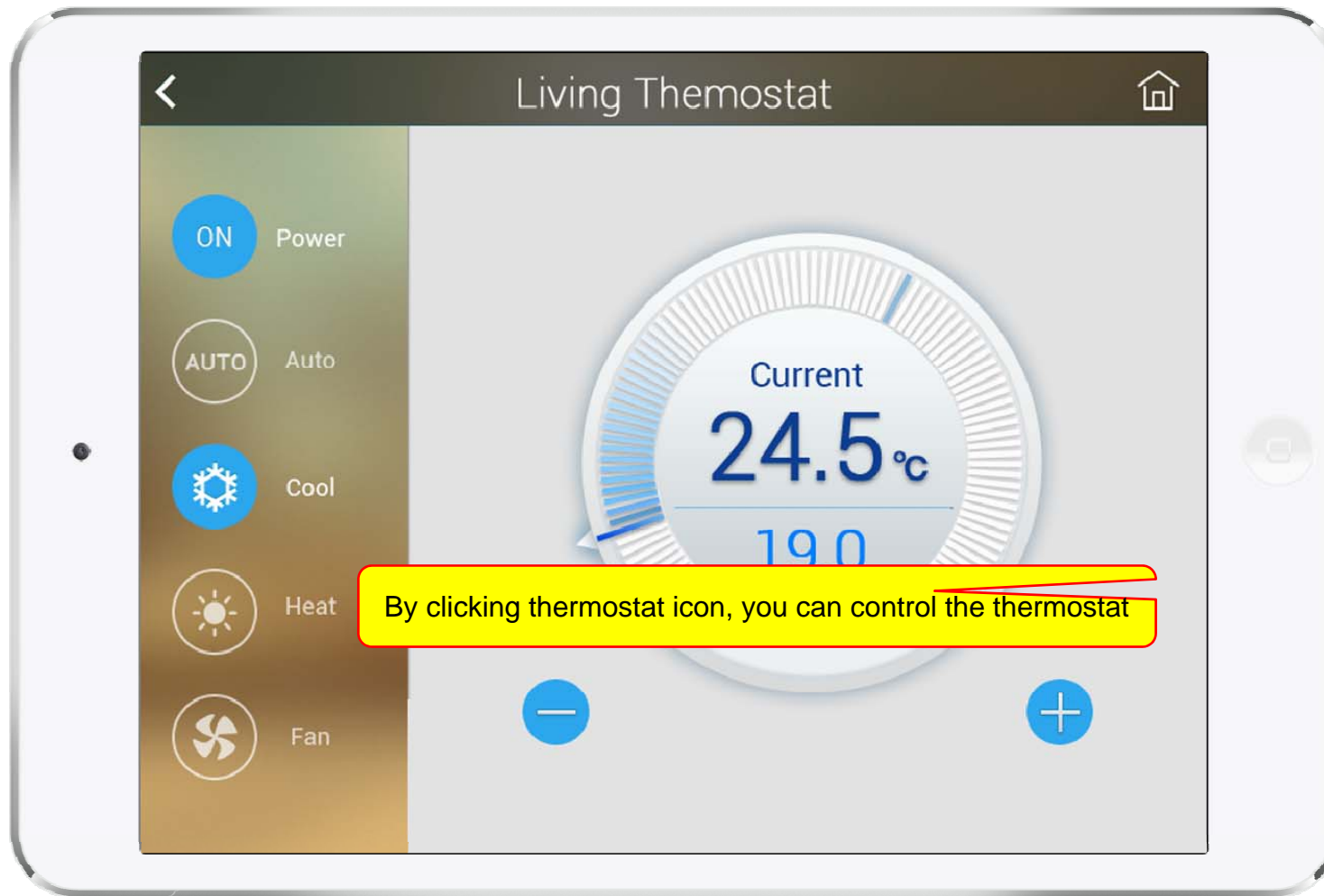

Action View

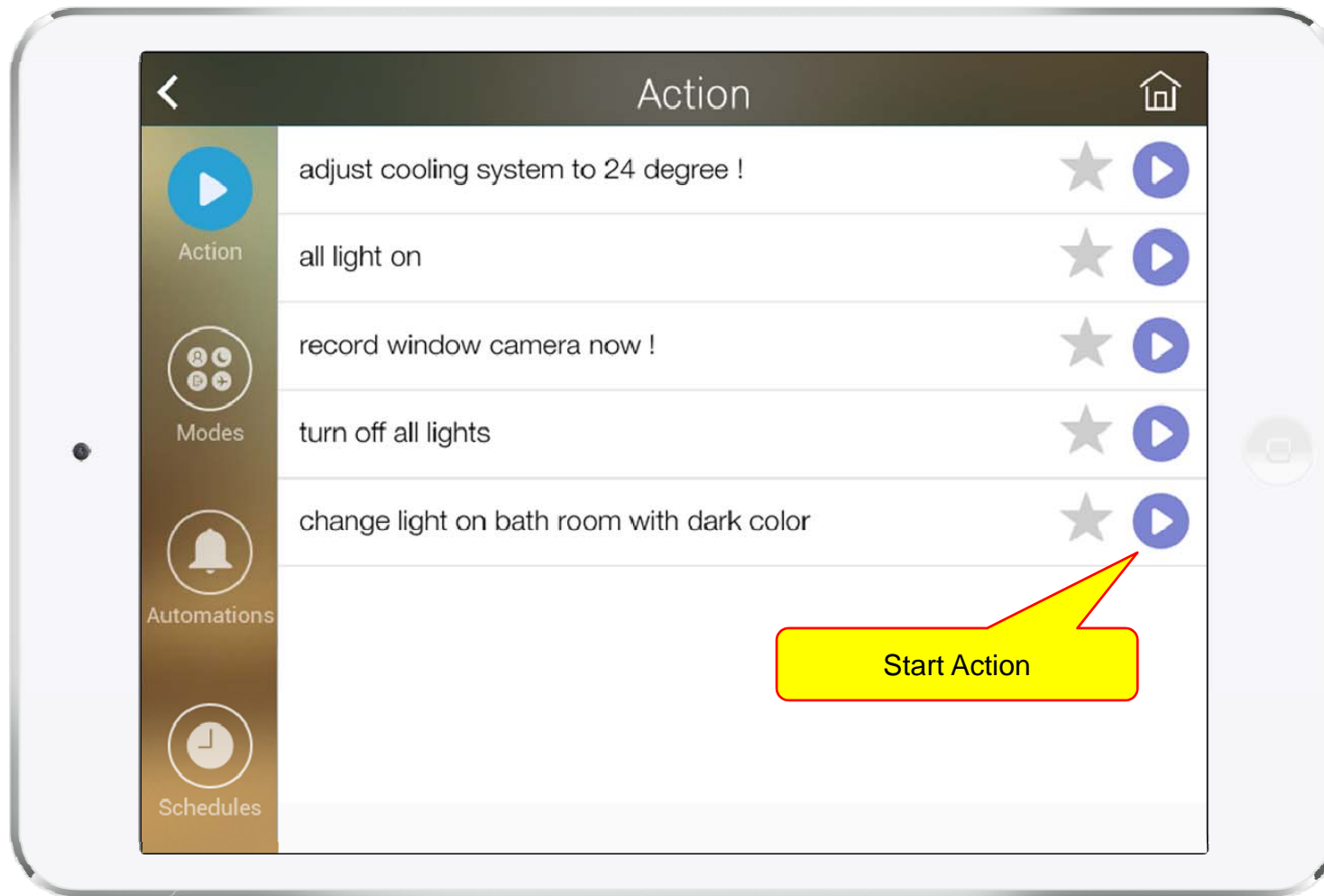

Mode View

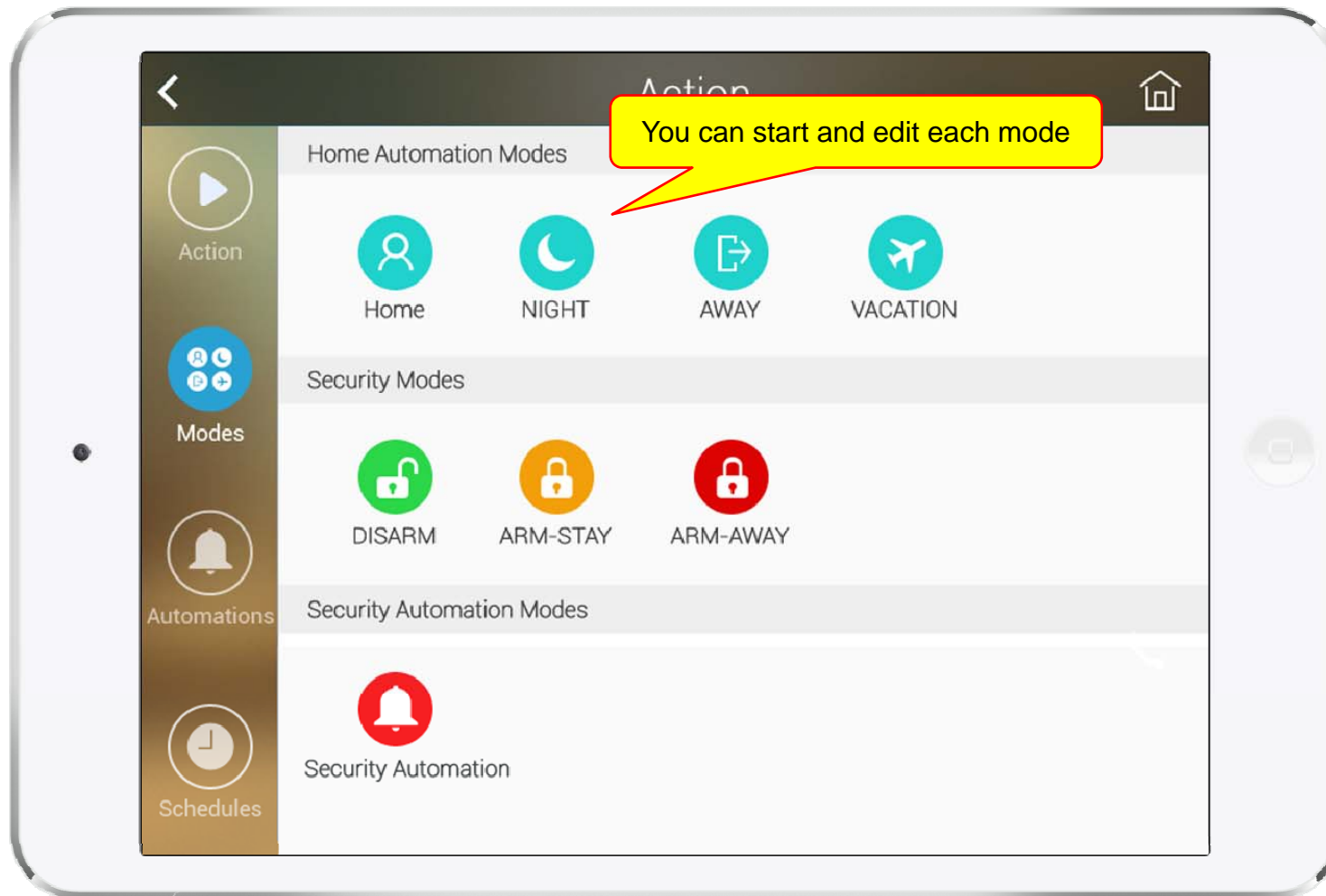

Alert View

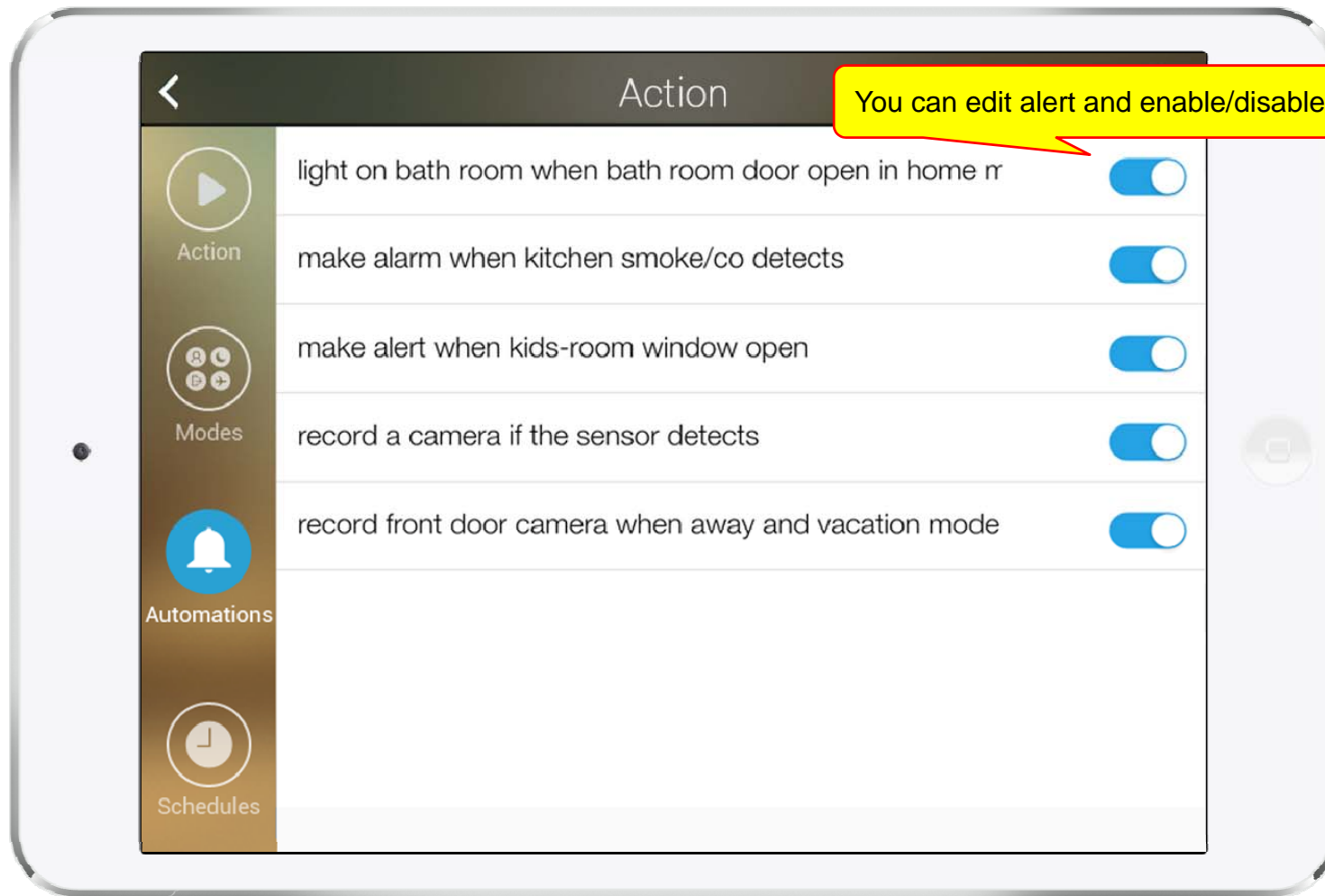

Schedule View

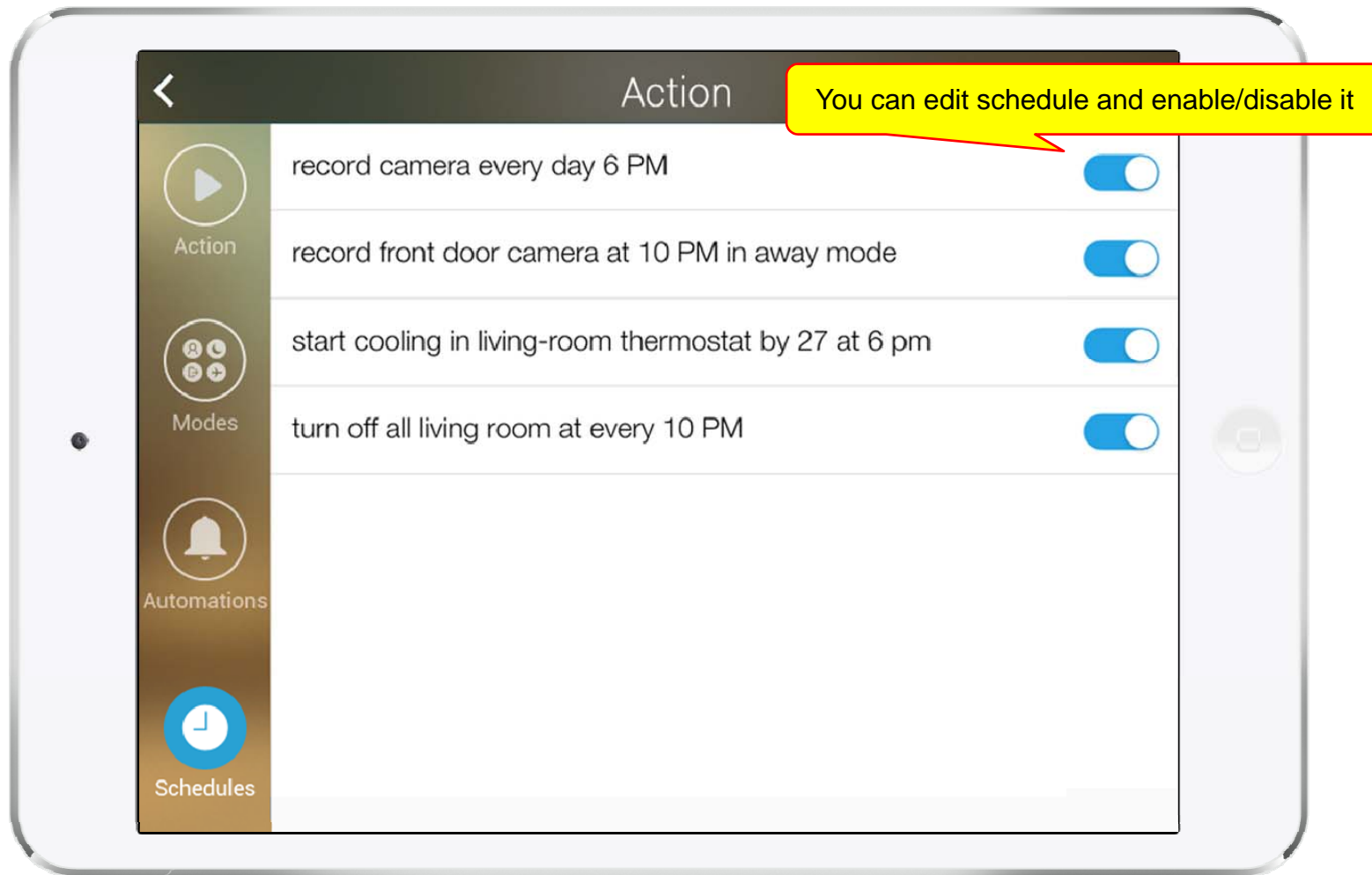

Setting Menu

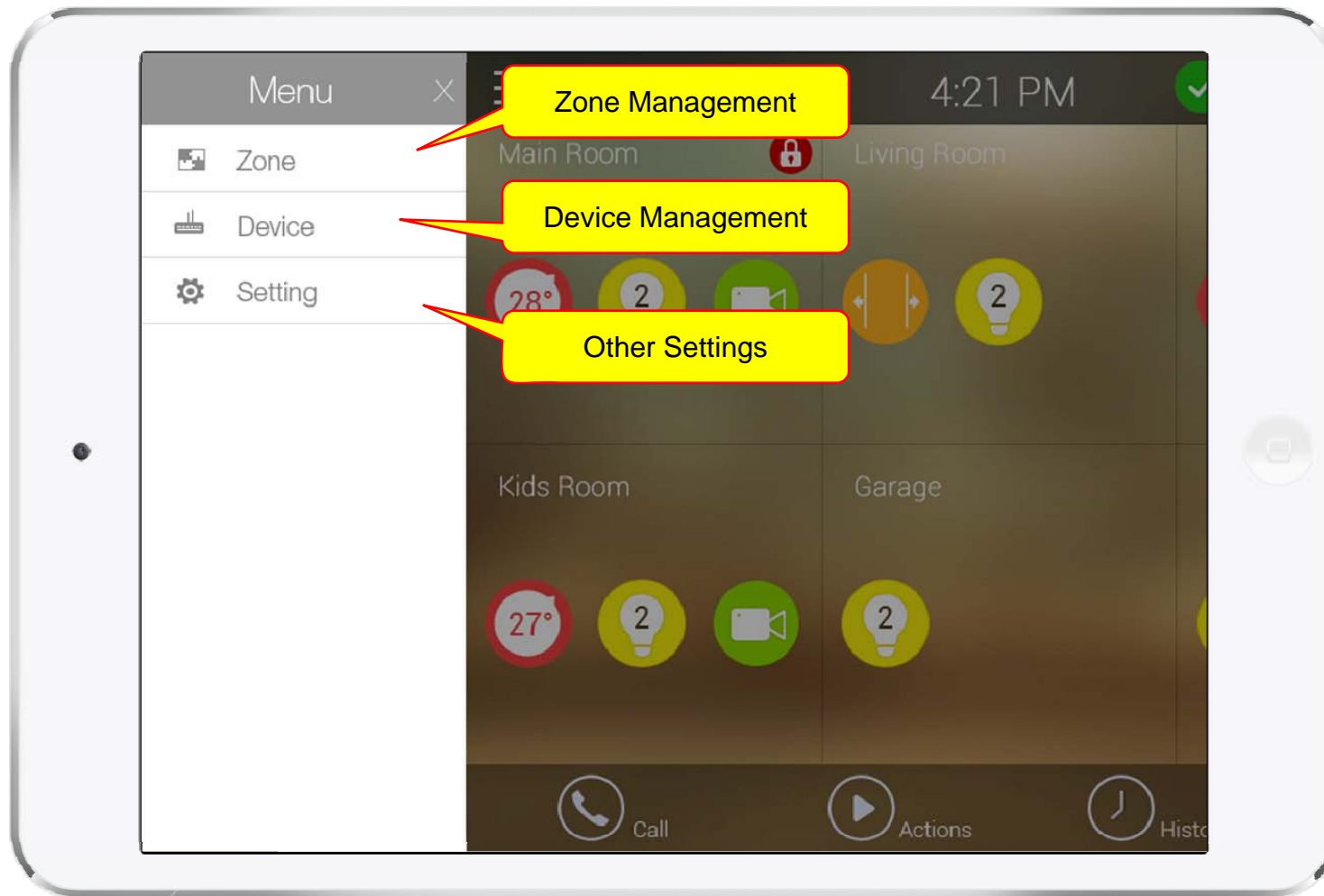



Thank you!

AddPac Technology Co., Ltd.
Sales and Marketing

Phone +82.2.568.3848 (KOREA)

FAX +82.2.568.3847 (KOREA)

E-mail : sales@addpac.com